

CO1 843 876

3011123
Page: 21 of 48
09/29/1998 03:35P
CHICAGO TITLE INSURANCE CO CCR 65.00 Clark County, WA

FILED
STATE OF WASHINGTON

WASH
RSE

RALPH WUNKER
SECRETARY OF STATE

ARTICLES OF INCORPORATION
WESTRIDGE PLACE HOMEOWNERS ASSOCIATION

I, a natural person of the age of eighteen (18) years or more, acting under the Revised Code of Washington, Chapter 24.03, sign in duplicate original the following Articles of Incorporation of a Washington Non-Profit Corporation.

ARTICLE I

The name of this corporation is WESTRIDGE PLACE HOMEOWNERS ASSOCIATION.

ARTICLE II

The existence of this corporation shall be perpetual.

ARTICLE III

The purpose of this corporation is the development, maintenance, repair and management of common areas, roadways, easements, wetlands, utilities and improvements, and recreation equipment and activities owned by the corporation and its members, as well as the review and approval of all plans for improvements to the property of Owners in the Westridge Place subdivision through the provisions contained in the Declaration of Covenants, Conditions and Restrictions of Westridge Place recorded as part of the Westridge Place subdivision. It is the purpose of the corporation to undertake improvements, maintenance and activities that would benefit the members of the corporation.

Said corporation is organized exclusively for non-profit purposes.

ARTICLE IV

Each person or entity who is a record owner of any lot in the Westridge Place subdivision is entitled to membership and voting rights in this Association. Membership is appurtenant to, and inseparable from, ownership of such lot.

ARTICLE V

The address of the initial registered office of this corporation is 915 Broadway, Suite 300, Vancouver, WA 98660. The name of the corporation's initial registered agent at that address is Mark F. Stoker.

ARTICLE VI

No part of the net earnings of this corporation shall inure to the benefit of, or be distributable to its members, directors, trustees, officers or other private persons, except that the corporation shall be authorized and empowered to pay reasonable compensation for services rendered and to make payments and distributions in furtherance of the purposes set forth in Article III hereof. Notwithstanding any other provision of these Articles, the corporation shall not carry on any other activities not permitted to be carried on (a) by a corporation exempt from Federal income tax under Section 501 (c)(3) of the Internal Revenue Code of 1954 (or the corresponding provision of any future United States Internal Revenue Law) or (b) by a corporation, contribution to which are deductible under Sections 170 (c)(2) of the Internal Revenue Code of 1954 (or the corresponding provision of any future United States Internal Revenue Law).



ARTICLE VII

Upon dissolution of this corporation the Board of Directors shall, after paying or making provision for the payment of all the liabilities of the corporation, dispose of the remaining assets of the corporation exclusively for the purposes of the corporation, or by gift or donation to such organization or organizations organized and operated exclusively for charitable, educational, religious, literary or scientific purposes as shall at the time qualify as an exempt organization or organizations under Section 501 (c)(3) of the Internal Revenue Code of 1954 (or the corresponding provision of any future United States Internal Revenue Law).

ARTICLE VIII

The affairs of this corporation shall be governed by a Board of Directors. Their number shall be fixed by the Bylaws, but the initial Board of Directors shall be no fewer than three (3) directors, and shall consist of the following:

Rick Bowler
313 SE 199th Ave
Camas, WA 98607

Cheri Styves
313 SE 199th Ave
Camas, WA 98607

Marilee Thompson
313 SE 199th Ave
Camas, WA 98607

ARTICLE IX

Amendment of the provisions of these Articles of Incorporation require the approval of two-thirds (2/3) vote of the lot owners.

ARTICLE X

As long as the Declarant (as that term is defined in the Declaration of
ARTICLES OF INCORPORATION-3



Covenants, Conditions and Restrictions encumbering the Westridge Place property) has control as provided in such Declaration, there shall be no annexation of additional properties, mergers and consolidations, mortgaging of common areas, dissolution and amendment of these Articles without the prior approval of HUD/VA.

ARTICLE XI

No director or officer of the corporation, or member of the Architectural Control Committee shall be personally liable to the corporation or its members for monetary damages for conduct in such capacity, except for liability of such person for (i) acts or omissions that involve intentional misconduct or a knowing violation of law by such person, or (ii) any transaction from which such person will personally receive a benefit in money, property or services to which such person is not legally entitled. If the Washington Nonprofit Corporation Act is amended to authorize corporate action further eliminating or limiting the personal liability of directors or officers, then the liability of a directors or officers of the corporation shall be eliminated or limited to the fullest extent permitted by the Washington Nonprofit Corporation Act, as so amended. Any repeal or modification of the foregoing paragraph by the members of the corporation shall not adversely affect any



right or protection of such person existing at the time of such repeal or modification.

ARTICLE XII

The corporation shall indemnify its directors and officers and members of the Architectural Control Committee against all liability, damage, or expense resulting from the fact that such person is or was a director or officer or member of the A.C.C., to the maximum extent and under all circumstances permitted by law; except that the corporation shall not indemnify a director or officer or member of the A.C.C. against liability, damage or expense resulting from such person's gross negligence.

I, therefore, for the purpose of organizing this corporation under the laws of the State of Washington, sign in duplicate original these Articles of Incorporation.

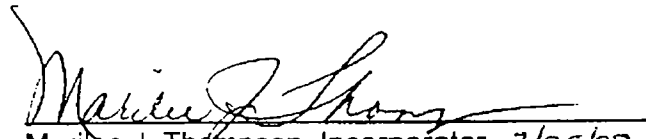

Marilee J. Thompson, Incorporator 3/25/97



CONSENT TO APPOINTMENT AS REGISTERED AGENT

I, MARK F. STOKER, hereby consent to serve as registered agent, in the state of Washington, for the corporation herein named. I understand that as agent for the corporation, it will be my responsibility to accept Service of Process in the name of the corporation; to forward corporate license renewal mailings to the corporation; and to immediately notify the Office of the Secretary of State in the event of my resignation or of any change in the Registered Office address of the corporation for which I am agent.

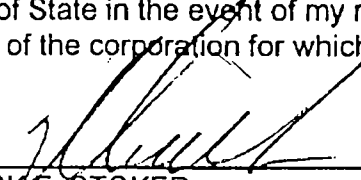
Date: 3/25/97



MARK F. STOKER

Address of Registered Agent:

915 Broadway, Suite 300
Vancouver, WA 98660



ARTICLE XIII

Incorporator

The name of the incorporator of the corporation is Marilee J. Thompson. The street address of the incorporator is 313 SE 199th Avenue, Camas, W 98607.



3011123

Page: 28 of 48
09/29/1998 03:35P
Clark County, WA

CHICAGO TITLE INSURANCE CO CCR 55.00

52670031.leg

LEGAL DESCRIPTION FOR WESTRIDGE
Perimeter Legal Description

April 08, 1998

A parcel of property located in Section 32, Township 2 North, Range 3 East of the Willamette Meridian in Clark County, Washington described as follows:

COMMENCING at the Northeast corner of the Northwest quarter of said Section 32;

THENCE South 01° 18' 42" West along the East line of said Northwest quarter 466.62 feet to the Northeast corner of the tract conveyed by deed to A.L. Eggebraaten under Auditor's File # 8501110026, records of Clark County and the TRUE POINT OF BEGINNING;

THENCE South 01° 18' 42" West along the East line of said Eggebratten tract 343.10 feet to the Northwest corner of Lot 6, Country Ridge 2, recorded in Book H of Plats at page 264, records of Clark County;

THENCE South 88° 54' 59" East along the North line of said Lot 6 a distance of 268.98 feet to the Northeast corner thereof;

THENCE South 01° 18' 42" West along the East line of said Lot 6 a distance of 1913.85 feet to the Easterly projection of the North line of that tract conveyed by deed to S.F. Flores under Auditor's File # 8707230069, records of Clark County;

THENCE North 88° 07' 46" West along said North line and it's Easterly projection 530.00 feet to the East line of Lot 5 Country Ridge-1, recorded in Book H of Plats at page 263, records of Clark County;

THENCE South 01° 22' 19" West along said East line 526.00 feet;

THENCE South 53° 03' 17" West 355.12 feet;

THENCE North 88° 37' 41" West 160.00 feet to the West line of said Lot 5;

THENCE North 01° 22' 19" East along said West line of Lot 5 a distance of 750.00 feet to the Northeast corner of the William S. Bennington Donation Land Claim;

THENCE North 88° 07' 46" West along the North line of said Bennington Donation Land Claim 1945.57 feet to the West line of said Section 32;



52670031.leg

THENCE North 01° 11' 11" East along said West line 554.74 feet to the Southwest corner of that tract conveyed by deed to Clark County under Auditor's File #9510130305, records of Clark County:

THENCE along the South line of said Clark County tract the following courses:

THENCE South 88° 07' 46" East 770.00 feet;

THENCE South 01° 52' 14" West 90.00 feet;

THENCE South 88° 07' 46" East 50.00 feet;

THENCE North 01° 52' 14" East 90.00 feet;

THENCE South 88° 07' 46" East 90.00 feet;

THENCE North 44° 00' 29" East 404.54 feet to the North line of the South 25.96 acres of said Government Lot 6;

THENCE South 88° 07' 46" East along said North line of the South 25.96 acres, 138.55 feet to the East line of the West half of said Northwest quarter of Section 32;

THENCE North 01° 14' 58" East along said East line of the West half, 1170.90 feet to the North line of "Tract B" as conveyed to Robert C. Hitchcock by deed recorded under Auditor's File No. G 306895;

THENCE South 88° 54' 00" East along the North line of said Hitchcock tract, 624.92 feet to the Southeast corner of that Short Plat recorded in Book 1 of Short Plats at page 609, records of Clark County;

THENCE North 01° 18' 21" East along the East line of said Short Plat 676.45 feet to the North line of said Section 32;

THENCE South 88° 54' 00" East along said North line 30.00 feet to the Northwest corner of that Short Plat recorded under Book 1 of Short Plats, at page 608, records of Clark County;

THENCE South 01° 18' 42" West along the West line of said Short Plat 466.62 feet to the Southwest corner thereof;

THENCE South 88° 54' 00" East along the South line of said Short Plat 466.62 feet to the Southeast corner thereof;



301123

Page: 30 of 48
09/29/1998 03:35P
65.00 Clark County, WA

CHICAGO TITLE INSURANCE CO CCR

52670031.leg

THENCE North 01° 18' 42" East along the East line of said Short Plat 466.62 feet to the North line of said Section 32;

THENCE South 88° 54' 00" East along said North line 60.00 feet to the most Northerly Northeast corner of said Eggebraaten tract (Auditor's File # 8501110026);

THENCE South 01° 18' 42" West along the East line of said Eggebraaten tract 466.62 feet to an angle point in the North line of said Eggebraaten tract;

THENCE South 88° 54' 00" East along the North line of said Eggebraaten tract 143.28 feet to the TRUE POINT OF BEGINNING.

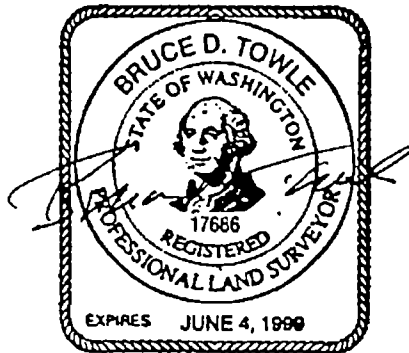

4/28/98



301123

Page: 31 of 48
09/29/1998 03:35P

CHICAGO TITLE INSURANCE CO. CCR

55 00 Clark County, WA

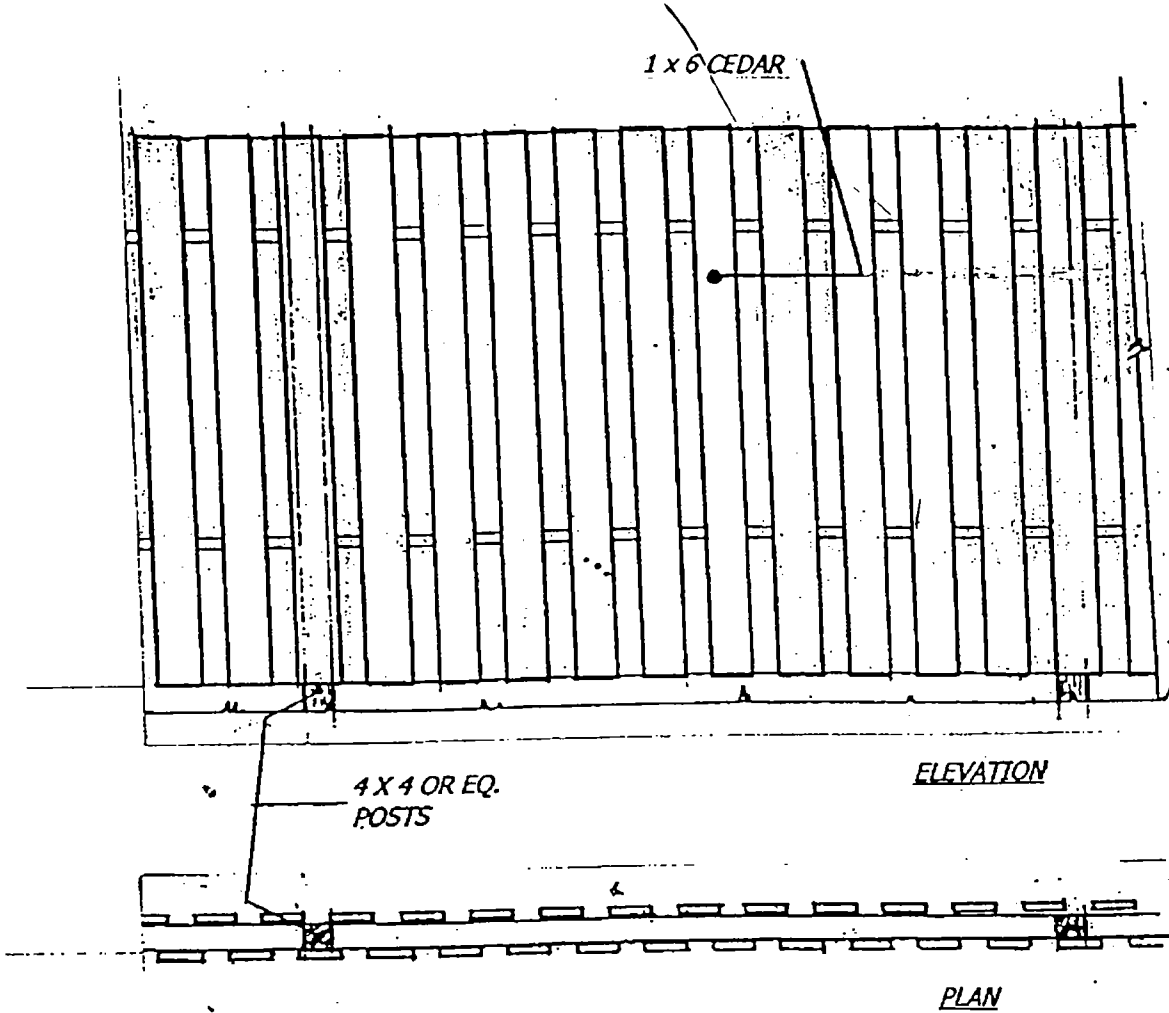

SIDE YARD FENCE

EXHIBIT "A"

4.4.4



3011123

Page: 32 of 48

09/29/1998 03:35P

CHICAGO TITLE INSURANCE CO CCR

55.00 Clark County, WA

1x6 CEDAR

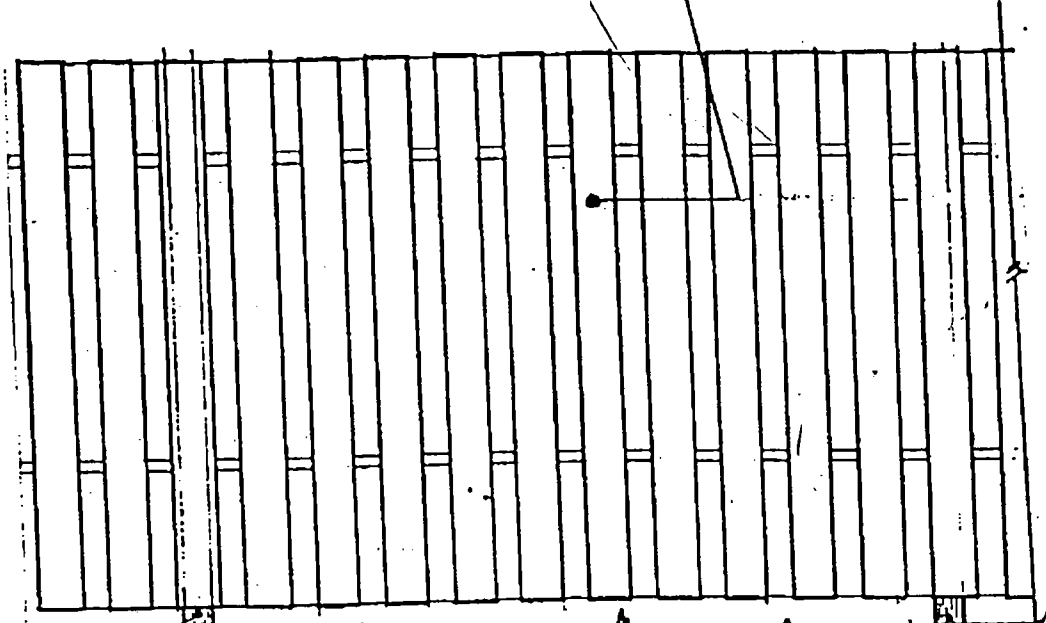

4x4 OR EQ.
POSTS

ELEVATION

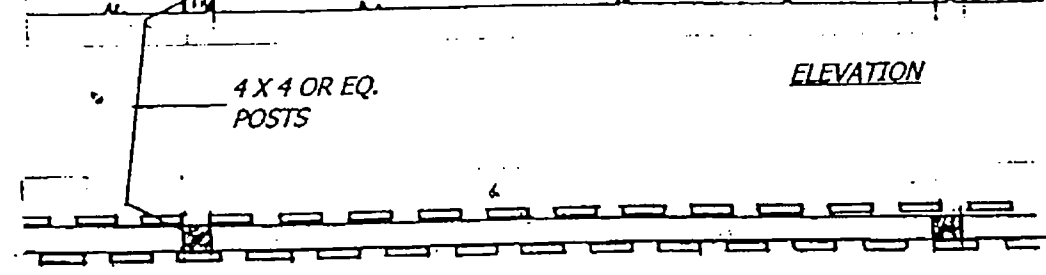

PLAN

PERIMETER FENCE

EXHIBIT "B"



3011123

Page: 33 of 48

09/29/1998 03:35P

CHICAGO TITLE INSURANCE CO CCR

55.00 Clark County, WA

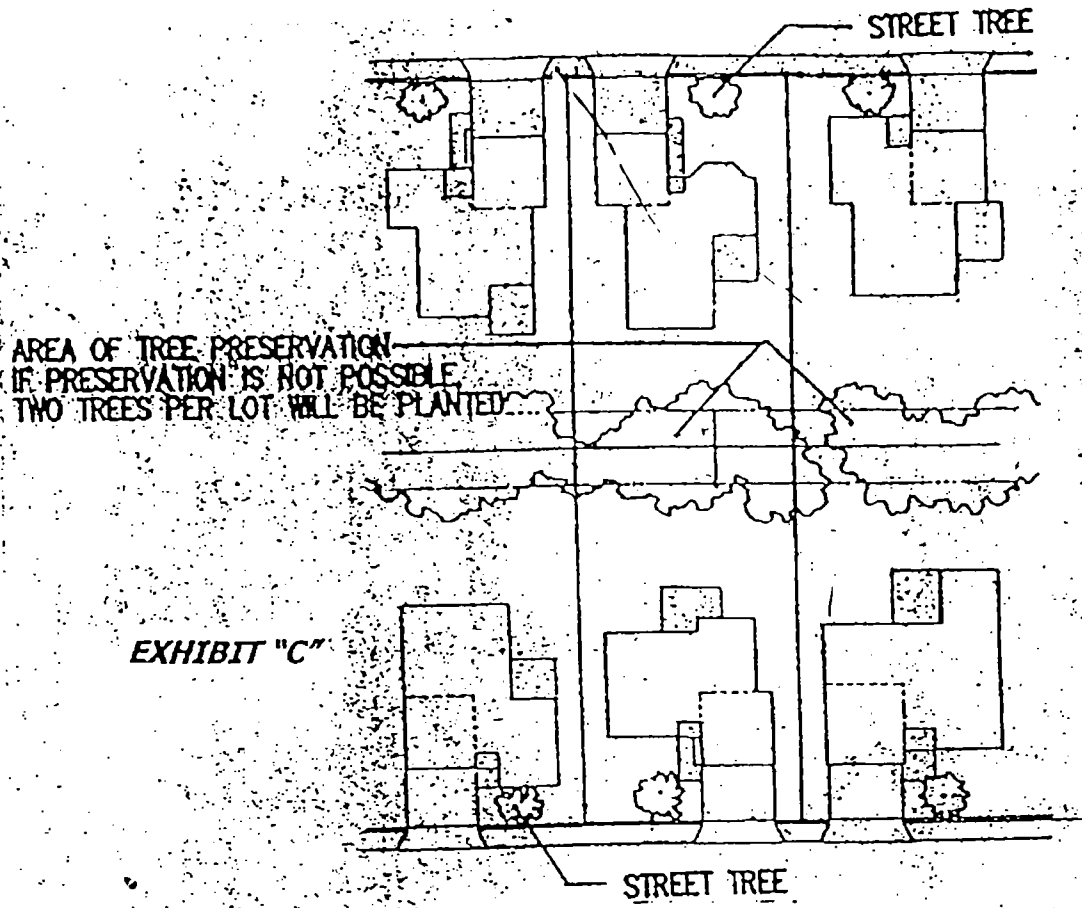

TREE PRESERVATION DETAIL

STREET TREE PLAN

STREET	STREET TREES	SIZE
SE 5th, 6th, 11th SE 19th, 19th & SE 19th (North of SE 6th) SE 200th (North of SE 6th)	Korean Dogwood (Korea Dogwood) (Tree form, high branching)	2' cal
SE 7th, 8th SE 19th (North of SE 9th) SE 200th (North of SE 8th) SE 9th (East of gate)	Chanticleer Flowering Pear (Pyrus cal. 'Chanticleer')	2' cal
SE 3rd, 4th, 15th & SE 9th (North of Heeridge)	Columnar Sargent Cherry (Pyrus Sargentii 'Column')	2' cal
SE 201st & 9th (East of gate)	Japanese Stewartia (Stewartia pseudocanella)	2' cal



3011123
 Page: 34 of 48
 08/29/1998 03:35P
 Clark County, WA

CHICAGO TITLE INSURANCE CO CCR 55 00

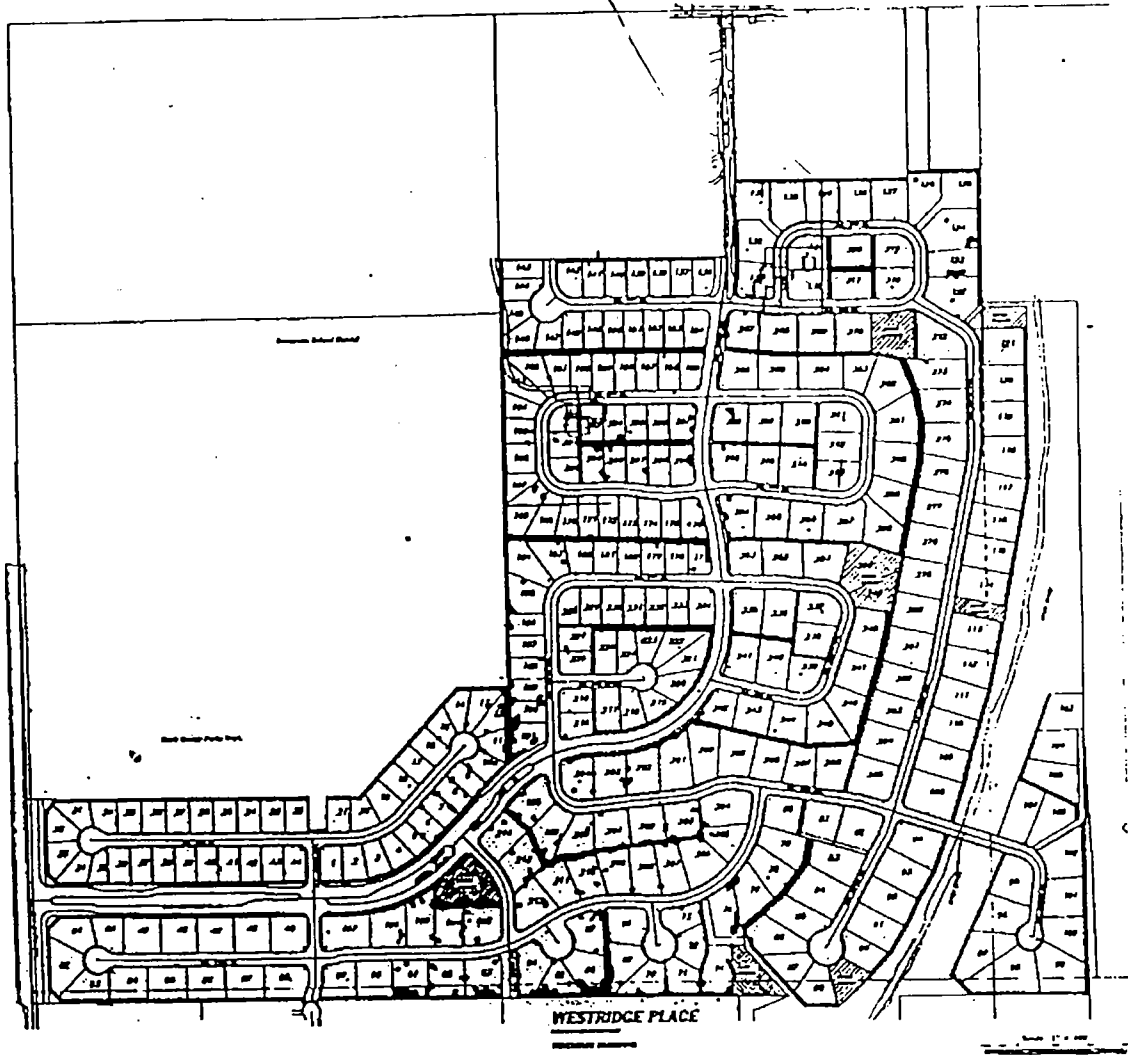

EXHIBIT "D"